

FTCS SERIES

Traction /compression load cell S type internal

Réf : 3300

Rev : F

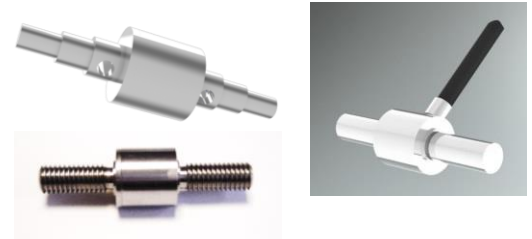

DESCRIPTION

This type of miniature sensor is intended for tensile and compression force measurements. Its not too expensive device with very good sensitivity and small design

MEASURING RANGE (FS)

Measurement range in Newton	10	20	50	100	200
Permissible overload	1.5 x EM	1.5 x EM	1.5 x EM	1.5 x EM	1.5 x EM
Material	Stainless steel	Stainless steel	Stainless steel	Stainless steel	Stainless steel

TECHNICAL DATA

PARAMETERS	Values	NOTES
Supply voltage	10 Vdc	
Operating temperature	-30°C ... 70°C	
Storage temperature	-50°C ... 85°C	
Compensated temperture	0°C ... 60°C	
Signal drift	<2% of FS /50°C	Within the compensated range
Offset drift	<2% of the value /50°C	Within the compensated range
Precision	± 1%	
Linearity	± 0.5%	
Hysteresis	± 0.5%	
Sensibility	7 mV/V	3 mV/V pour 10N
Offset	± 0.5% of the FS	
Isolation	≥ 1000 MΩ at 50 Vcc	
Insiultation	IP55	
Thread	M3/M5	
Input Impedance	1kΩ à 3kΩ	
Ouput Impedance	500Ω à 1kΩ	
Output	Cable	2m as standard
Calibration	Tensile / Compression	
Material	Z8CND17-04 (APX4)	

DIMENSIONS

FTCS---NM3-10

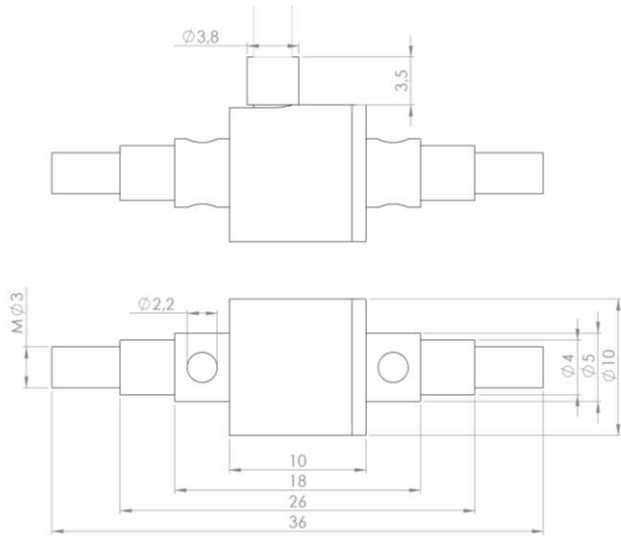

FTCS---NM5-10

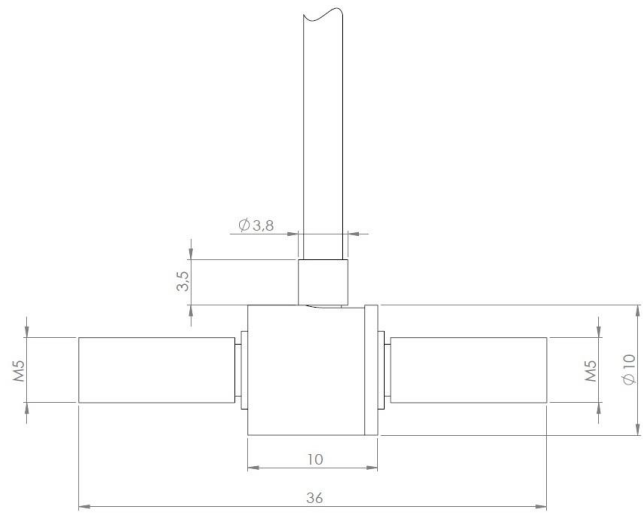

ELECTRICAL DIAGRAM

FTCS

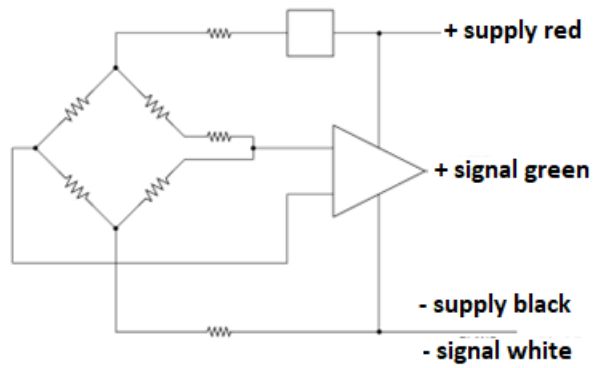
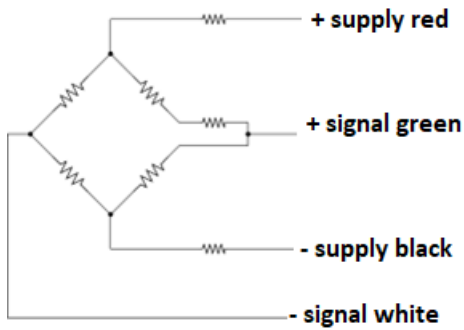

ORDER INFORMATION

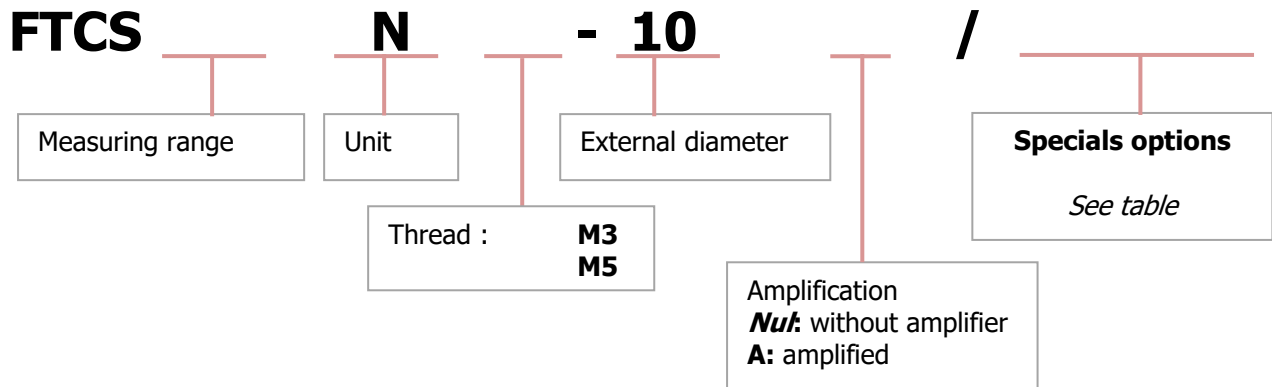

- **Specials options**

OPTION	Description
Cable length	Length in meter (M) 2m as standard

Exemple: **FTCS10NM3-10A / 1.5M**

- External diameter : \varnothing 10
- Measuring range : 10 N
- Thread : M3
- Amplified
- cable length : 1.5 meter

FTCS50NM5-10

- External diameter : \varnothing 10
- Measuring range : 50 N
- Thread : M5
- Without amplify
- Cable length : 2 meters

CONTACT

G.R.D.I.A MESUREX
 13 Rue des Corroyés
 78730 Saint Arnoult en Yvelines
 FRANCE

Tel : +33 (0) 1 30 41 23 62
 Fax : +33 (0) 1 30 41 23 80
 Mail : mesurex@mesurex.fr