

PASSAGES ETANCHES ACIER INOX

Double cone

Ref : PE-XX-XX (métrique)(BSPP)(G)

Rev : A

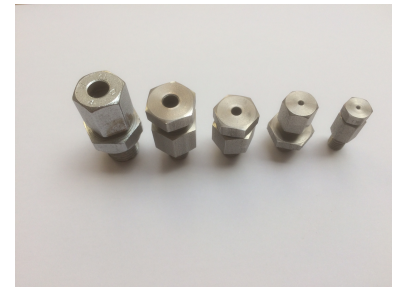

CARACTÉRISTIQUES TECHNIQUES

Version métrique

REFERENCE	PAS	A (Ø)	B	C	D	E	F	G
PE1 M8	M8X1	1mm	7.9	8	7.5	14.2	22	13.6
PE1.5 M8	M8X1	1.5mm	7.9	8	7.5	14.2	22	13.6
PE2 M8	M8X1	2mm	7.9	8	7.5	14.2	21	13.6
PE3 M8	M8X1	3mm	11.2	12	7.5	14.2	25	13.6
PE4 M8	M8X1	4mm	12.7	12	7.5	14.2	25	13.6
PE4.5 M8	M8X1	4.5mm	12.7	12	7.5	14.2	25	13.6
PE3 M10	M10X1	3mm	11.1	12	11	17.5	27.5	16.5
PE4.5 M10	M10X1	4.5mm	12.7	12	11	17.5	28	16.5
PE6 M10	M10X1	6mm	14.2	12	11	17.5	29	16.5
PE6 M12	M12X1	6mm	14.2	12.7	11	17.5	29	16.5
PE8 M12	M12X1	8mm	14.2	13.5	11	17.5	30	16.5
PE3 M14	M14X1.5	3mm	11.1	12	11	19.1	27	18
PE6 M16	M16X1.5	6mm	14.2	12.7	11	22.2	28.5	21.4
PE6 M18	M18X1.5	6mm	14.2	12.7	11	22.2	28.5	21.4
PE1.5 M20	M20X1.5	1.5mm	7.9	13	11	25.4	28	24.5
PE3 M20	M20X1.5	3mm	11.1	13.5	11	25.4	28	24.5
PE6 M20	M20X1.5	6mm	14.2	12.7	11	25.4	32.7	24.5
PE8 M20	M20X1.5	8mm	16	13.5	11	25.4	33.7	24.5

PE8 M24	M24X1.5	8mm	16	13.5	16	30	40.5	29
---------	---------	-----	----	------	----	----	------	----

Version BSSP ou G

REFERENCE	PAS	A (Ø)	B	C	D	E	F	G
PE1.5 G1/4"	G1/4"	1.5mm	7.9	8	11.2	18.2	26.7	19.1
PE2 G1/4"	G1/4"	2mm	7.9	8	11.2	18.2	26.7	19.1
PE3 G1/4"	G1/4"	3mm	11.1	12	11.2	18.2	28.6	19.1
PE4 G1/4"	G1/4"	4mm	12.7	12	11.2	18.2	29.5	19.1
PE4.5 G1/4"	G1/4"	4.5mm	12.7	12	11.2	18.2	29.5	19.1
PE6 G1/4"	G1/4"	6mm	14.2	12.7	11.2	18.2	30.5	19.1
PE3 G1/2"	G1/2"	3mm	11.1	12	14.2	25.8	35.6	27
PE4 G1/2"	G1/2"	4mm	12.7	12	14.2	25.8	36.5	27
PE4.5 G1/2"	G1/2"	4.5mm	12.7	12	14.2	25.8	37.5	27
PE6 G1/2"	G1/2"	6mm	14.2	12.7	14.2	25.8	37.5	27
PE8 G1/2"	G1/2"	8mm	15.8	12.7	14.2	25.8	38.2	27

DIMENSIONS

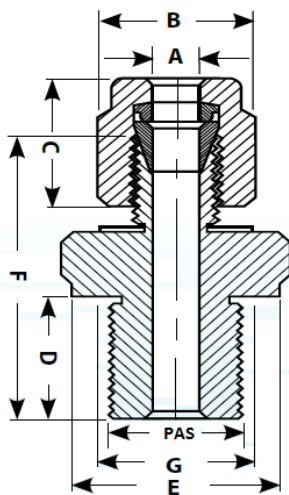

CONTACT

MESUREX
13 Rue des Corroyés
78730 Saint Arnoult en Yvelines

Tel : +33 (0) 1 30 41 23 62
Fax : +33 (0) 1 30 41 23 80
Mail : measurex@measurex.fr