

STATIC torque transducers

Series -CPRS

Réf : F FP 3506

Rev :



TECHNICAL DATA

STATIC NOMINAL TORQUE	0.5* – 2.5 N·m 5 – 10 – 25 – 50 – 100 N·m 250 – 500 -1000 N·m
LINEARITY and HYSTERESIS	≤ ± 0.20 %
TEMPERATURE EFFECT (1°C): a) on zero b) on sensitivity	≤ ± 0.02% ≤ ± 0.02%
NOMINAL SENSITIVITY SENSIVITY TOLERANCE	2mV/V (*0.5N·m: 1mV/V) ≤ ± 0.5%
Input resistance Output resistance	825 ± 50Ω 700 ± 2Ω
NOMINAL POWER SUPPLY MAX. POWER SUPPLY INSULATION RESISTANCE ZERO BALANCE	1-15V 18V >2 GΩ ≤ ± 1%
LIMIT MECHANICAL VALUES REFERRED TO NOMINAL TORQUE: a) service torque b) max. permissible torque c) breaking torque d) highly dynamic torque	100% 150% >300% 70%
REFERENCE TEMPERATURE WORKING TEMPERATURE RANGE STORAGE TEMPERATURE RANGE	+23°C -10/+70°C -20/+80°C
PROTECTION CLASS (EN 60529) SENSOR EXECUTION MATERIAL ELECTRICAL CONNECTION	IP40 INOX 17-4 PH Cable 5m
PROCESS COUPLING (UNI ISO 1174-1): 0.5 - 2.5 – 5 - 10 N·m 25 - 50 N·m 100 – 250 N·m 500 – 1000 N·m	■ 1/4" ■ 3/8" ■ 1/2" ■ 3/4"

DIMENSIONS

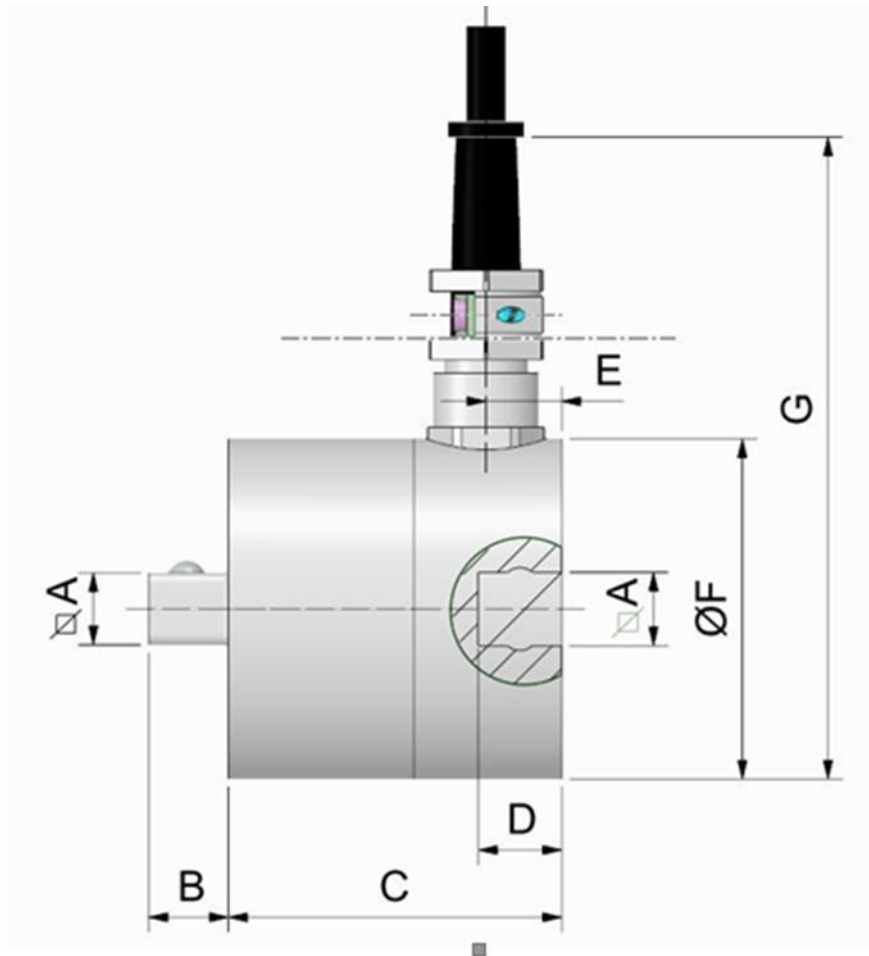

LOAD	■A	B	C	D	E	F	G
0.5 Nm	1/4"	7.5	44	8	10	45	85
2.5 Nm	1/4"	7.5	44	8	10	45	85
5 Nm	1/4"	7.5	44	8	10	45	85
10 Nm	1/4"	7.5	44	8	10	45	85
25 Nm	3/8"	10.5	44	11	10	45	85
50 Nm	3/8"	10.5	44	11	10	45	85
100 Nm	1/2"	15.0	44	16	10	45	85
250 Nm	1/2"	15.0	44	16	10	45	85
500 Nm	3/4"	22.5	53.5	24	17.5	51	91
1000 Nm	3/4"	22.5	53.5	24	17.5	51	91

ELECTRICAL CONNECTIONS

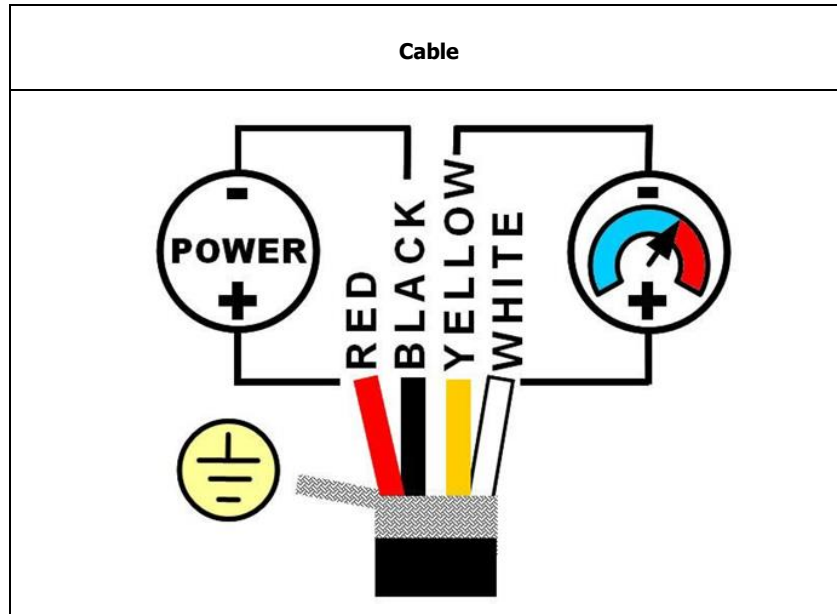

PVC 105°C shielded cable, Ø5.2mm with 4 tinned Ø0.35mm² conductors. Shield connected to the body of the torque meter

CONTACT

MESUREX

13 Rue des Corroyés
78730 Saint Arnoult en Yvelines

Tel : +33 (0) 1 30 41 23 62
Fax : +33 (0) 1 30 41 23 80
Mail : mesurex@mesurex.fr