

PASSAGES ETANCHES ACIER INOX

Double cone

Ref : PE-XX-XX (métrique)(BSPP)(G)

Rev : A

CARACTERISTIQUES TECHNIQUES

Versions métriques

REFERENCE	PAS	A (Ø)	B	C	D	E	F	G
PE1 M8	M8X1	1mm	7.9	8	7.5	14.2	22	13.6
PE1.5 M8	M8X1	1.5mm	7.9	8	7.5	14.2	22	13.6
PE2 M8	M8X1	2mm	7.9	8	7.5	14.2	21	13.6
PE3 M8	M8X1	3mm	11.2	12	7.5	14.2	25	13.6
PE4 M8	M8X1	4mm	12.7	12	7.5	14.2	25	13.6
PE4.5 M8	M8X1	4.5mm	12.7	12	7.5	14.2	25	13.6
PE3 M10	M10X1	3mm	11.1	12	11	17.5	27.5	16.5
PE4.5 M10	M10X1	4.5mm	12.7	12	11	17.5	28	16.5
PE6 M10	M10X1	6mm	14.2	12	11	17.5	29	16.5
PE6 M12	M12X1	6mm	14.2	12.7	11	17.5	29	16.5
PE8 M12	M12X1	8mm	14.2	13.5	11	17.5	30	16.5
PE3 M14	M14X1.5	3mm	11.1	12	11	19.1	27	18
PE3 M14	M14X1.5	9mm	17.5	14.2	11	19.1	30	18
PE6 M16	M16X1.5	6mm	14.2	12.7	11	22.2	28.5	21.4
PE6 M18	M18X1.5	6mm	14.2	12.7	11	22.2	28.5	21.4
PE1.5 M20	M20X1.5	1.5mm	7.9	13	11	25.4	28	24.5
PE3 M20	M20X1.5	3mm	11.1	13.5	11	25.4	28	24.5
PE6 M20	M20X1.5	6mm	14.2	12.7	11	25.4	32.7	24.5
PE8 M20	M20X1.5	8mm	16	13.5	11	25.4	33.7	24.5

PE8 M24	M24X1.5	8mm	16	13.5	16	30	40.5	29
---------	---------	-----	----	------	----	----	------	----

Versions BSPP OU G

REFERENCE	PAS	A (Ø)	B	C	D	E	F	G
PE3 G1/16"	G1/16"	3mm	11.1	12	7.1	10.6	23.7	14.3
PE1 G1/8"	G1/8"	1mm	7.9	8	7.1	13.8	22	14.2
PE1.5 G1/8"	G1/8"	1.5mm	7.9	8	7.1	13.8	22	14.2
PE2 G1/8"	G1/8"	2mm	7.9	8	7.1	13.8	22	14.2
PE3 G1/8"	G1/8"	3mm	11.1	12	7.1	13.8	23.7	14.2
PE4 G1/8"	G1/8"	4mm	12.7	12	7.1	13.8	24.6	14.2
PE4.5 G1/8"	G1/8"	4.5mm	12.7	12	7.1	13.8	24.6	14.2
PE6 G1/8"	G1/8"	6mm	14.2	12.7	7.1	13.8	25.7	14.2
PE6 G1/8"	G1/8"	8mm	15.8	13.5	7.1	13.8	26.3	14.2
PE1.5 G1/4"	G1/4"	1.5mm	7.9	8	11.2	18.2	26.7	19.1
PE2 G1/4"	G1/4"	2mm	7.9	8	11.2	18.2	26.7	19.1
PE3 G1/4"	G1/4"	3mm	11.1	12	11.2	18.2	28.6	19.1
PE4 G1/4"	G1/4"	4mm	12.7	12	11.2	18.2	29.5	19.1
PE4.5 G1/4"	G1/4"	4.5mm	12.7	12	11.2	18.2	29.5	19.1
PE6 G1/4"	G1/4"	6mm	14.2	12.7	11.2	18.2	30.5	19.1
PE8 G1/4"	G1/4"	8mm	15.8	13.5	11.2	18.2	31.2	19.1
PE3 G1/2"	G1/2"	3mm	11.1	12	14.2	25.8	35.6	27
PE4 G1/2"	G1/2"	4mm	12.7	12	14.2	25.8	36.5	27
PE4.5 G1/2"	G1/2"	4.5mm	12.7	12	14.2	25.8	37.5	27
PE6 G1/2"	G1/2"	6mm	14.2	12.7	14.2	25.8	37.5	27
PE8 G1/2"	G1/2"	8mm	15.8	12.7	14.2	25.8	38.2	27
PE9 G1/2"	G1/2"	9mm	17.5	14.2	14.2	25.8	38.7	27
PE10 G1/2"	G1/2"	10mm	17.5	14.2	14.2	25.8	38.7	27
PE11 G1/2"	G1/2"	11mm	22.2	17.5	14.2	25.8	38.7	27
PE12 G1/2"	G1/2"	12mm	22.2	17.5	14.2	25.8	39.5	27
PE1/2 G1/2"	G1/2"	½"	22.2	17.5	14.2	25.8	38.9	27

PE14 G1/2"	G1/2"	14mm	25.4	17.5	14.2	25.8	38.8	27
PE15 G1/2"	G1/2"	15mm	25.4	17.5	14.2	25.8	38.8	27
PE6 G3/4"	G3/4"	6mm	14.2	12.7	16	31	41.5	31.8
PE8 G3/4"	G3/4"	8mm	15.8	13.5	16	31	41.5	31.8
PE12 G3/4"	G3/4"	12mm	22.2	17.5	16	31	42.7	31.8
PE1/2 G3/4"	G3/4"	1/2"	22.2	17.5	16	31	42.7	31.8
PE15 G3/4"	G3/4"	15mm	25.4	17.5	16	31	41.5	31.8
PE6 G1"	G1"	6mm	14.2	12.7	18.2	40.5	42.7	41.3
PE8 G1"	G1"	8mm	15.8	13.5	18.2	40.5	43.4	41.3
PE12 G1"	G1"	12mm	22.2	17.5	18.2	40.5	43.9	41.3
PE1/2" G1"	G1"	1/2"	22.2	17.5	18.2	40.5	43.9	41.3
PE15 G1"	G1"	15mm	25.4	17.5	18.2	40.5	43.9	41.3
PE1" G1"	G1"	1"	38.1	20.5	18.2	40.5	47.8	41.3

DIMENSIONS

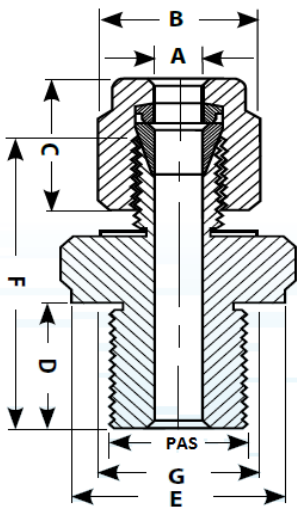

Versions BSPT OU R (CONIQUE)

REFERENCE	PAS	A (Ø)	B	C	D	E	F
PE3 R1/16"	R1/16"	1mm	8	8	9.5	8	22
PE1 R1/8"	R1/8"	1mm	7.9	8	9.6	11.1	22.1
PE1.5 R1/8"	R1/8"	1.5mm	7.9	8	9.6	11.1	22.1
PE2 R1/8"	R1/8"	2mm	7.9	8	9.6	11.1	22.1
PE3 R1/8"	R1/8"	3mm	11.1	12	9.6	11.1	23.8
PE4 R1/8"	R1/8"	4mm	12.7	12	9.6	11.1	24.9
PE4.5 R1/8"	R1/8"	4.5mm	12.7	12	9.6	11.1	24.9
PE6 R1/8"	R1/8"	6mm	14.2	12.7	9.6	11.1	25.4
PE1/4 R1/8"	R1/8"	¼"	14.2	12.7	9.6	11.1	25.4
PE1.5 R1/4"	R1/4"	1.5mm	8	8	14.2	14.2	27.3
PE2 R1/4"	R1/4"	2mm	8	8	14.2	14.2	27.3
PE3 R1/4"	R1/4"	3mm	11.1	12	14.2	14.2	28.9
PE4 R1/4"	R1/4"	4mm	12.7	12	14.2	14.2	29.5
PE4.5 R1/4"	R1/4"	4.5mm	12.7	12	14.2	14.2	29.5
PE6 R1/4"	R1/4"	6mm	14.3	12.7	14.2	14.2	30.7
PE8 R1/4"	R1/4"	8mm	15.8	13.5	14.2	14.2	31.2
PE3 R1/2"	R1/2"	3mm	11.1	12	19	22.2	35.5
PE4 R1/2"	R1/2"	4mm	12.7	12	19	22.2	36.5
PE4.5 R1/2"	R1/2"	4.5mm	12.7	12	19	22.2	36.5
PE6 R1/2"	R1/2"	6mm	14.2	12.7	19	22.2	37.3
PE8 R1/2"	R1/2"	8mm	15.8	13.5	19	22.2	38.2
PE10 R1/2"	R1/2"	10mm	17.5	14.2	19	22.2	38.7
PE12 R1/2"	R1/2"	12mm	22.2	17.5	19	22.2	38.7
PE1/2 R1/2"	R1/2"	½"	22.2	17.5	19	22.2	38.7
PE15 R1/2"	R1/2"	15mm	25.4	17.5	19	22.2	38.7
PE6 R3/4"	R3/4"	6mm	14.2	12.7	19	27	38.6
PE8 R3/4"	R3/4"	8mm	15.8	13.5	19	27	39.8
PE12 R3/4"	R3/4"	12mm	22.2	17.5	19	27	40.3

PE1/2 R3/4"	R3/4"	1/2"	22.2	17.5	19	27	40.3
PE15 R3/4"	R3/4"	15mm	25.4	17.5	19	27	40.3
PE1 R3/4"	R3/4"	1"	38.1	20.5	19	27	42.2
PE6 R1"	R1"	6mm	14.2	12.7	23.5	34.9	42
PE1/4 R1"	R1"	1/4"	14.2	12.7	23.5	34.9	42
PE1" R1"	R1"	1"	38.1	20.5	23.5	34.9	46.7

DIMENSIONS

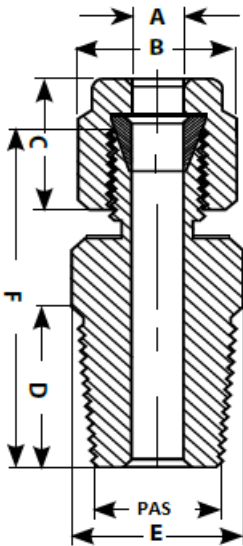

CONTACT

G.R.D.I.A MESUREX

13 Rue des Corroyé
 78730 Saint Arnoult en Yvelines
 Tel : +33 (0) 1 30 41 23 62
 Fax : +33 (0) 1 30 41 23 80
 Mail : mesurex@mesurex.fr